

ROGERS STREET
(CITY OF GLOUCESTER)

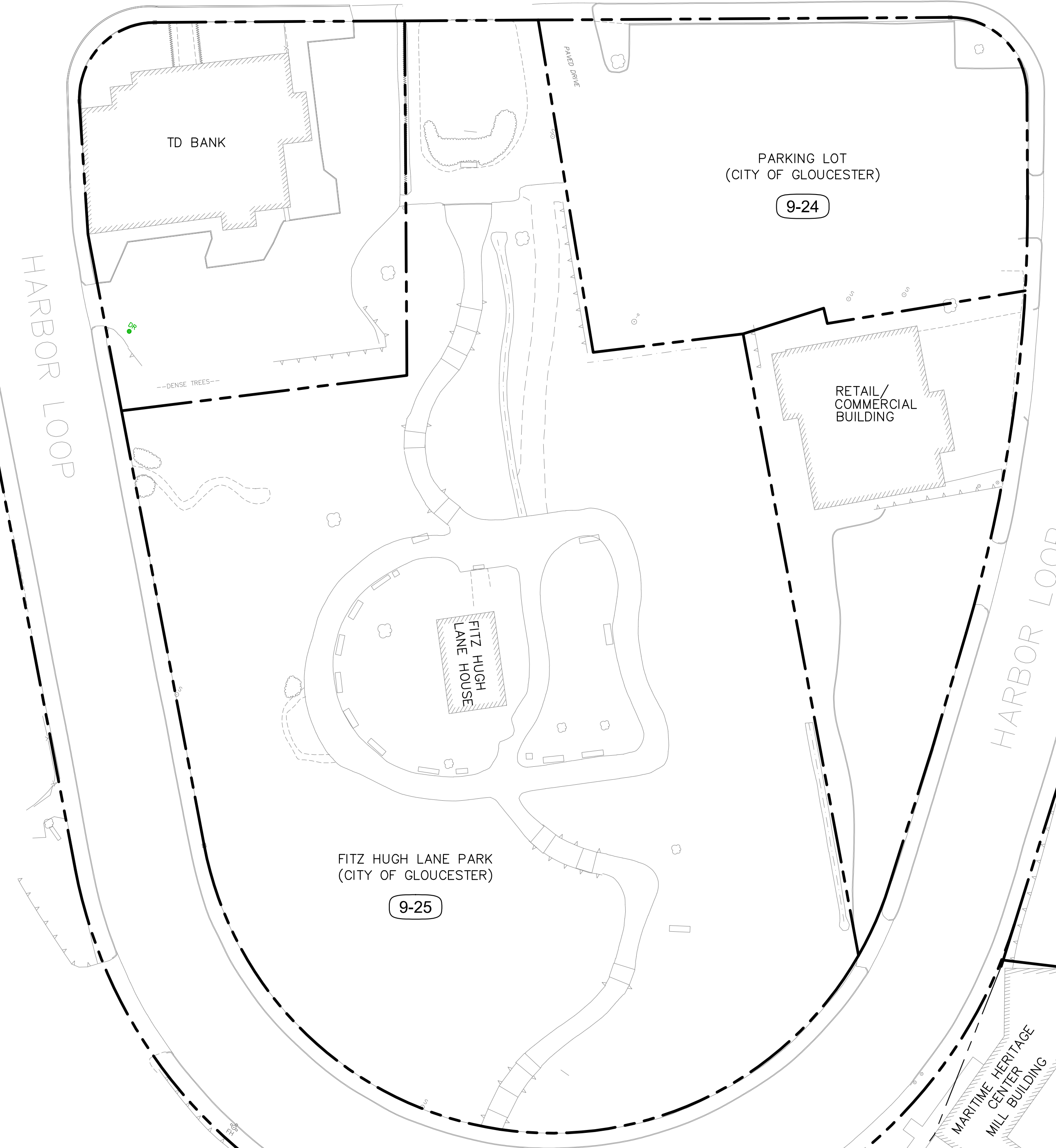

8-25 1907, LLC 8-2

10-30
AMERICOLD

10-31
STAR REALTY
MANAGEMENT
(AKA STAR FISHERIES)

HARBOR LOOP

MARITIME HERITAGE
MIL CENTER
BUILDING

9-18

9-21

INTERSHELL
INTERNATIONAL

9-12

9-19

9-20

MARITIME HERITAGE
OFFICE BUILDING

MARITIME HERITAGE
COACH HOUSE

9-16

9-17

MARITIME HERITAGE
BOAT HOUSE
CENTER

NATIONAL
GRID BLDG

9-14

SOLOMON
JACOBS
PARK

9-13

U.S. COAST GUARD

9-11

GLOUCESTER INNER HARBOR

LEGEND

	CHAIN LINK FENCE
	EDGE OF WOODED AREA/PLANTED AREA
	EDGE PAVEMENT
	SEA WALL
	FORMER SEA WALL
	PROPERTY LINE
	ASSESSOR'S LINE
	CITY OF GLOUCESTER ASSESSOR'S MAP AND LOT NUMBER
	APPROXIMATE LOCATION OF EXISTING BUILDING/STRUCTURE

NOTES

1) EXISTING SITE FEATURES SHOWN HEREON OBTAINED FROM FIELD SURVEY PERFORMED BY HANCOCK ASSOCIATES OF DANVERS, MA.



FORMER GLOUCESTER
GAS LIGHT COMPANY
MGP FACILITY
GLOUCESTER, MASSACHUSETTS

PROPERTY LOT MAP

PREPARED BY: 	PREPARED FOR:
DESIGNED BY: JRP	CHECKED BY: MJB
DRAWN BY: JRC	SCALE: AS NOTED
DATE: JULY 2011	PROJECT NO.: 101000003.00
	SHEET NO. 2A

THE INFORMATION SHOWN ON THIS DRAWING IS SOLELY FOR USE BY NATIONAL GRID OR ITS AFFILIATED COMPANIES AND IS NOT TO BE REPRODUCED OR TRANSMITTED IN ANY FORM OR BY ANY MEANS, ELECTRONIC OR MECHANICAL, INCLUDING PHOTOCOPYING, RECORDING, OR BY ANY INFORMATION STORAGE AND RETRIEVAL SYSTEM, WITHOUT THE WRITTEN PERMISSION OF NATIONAL GRID. NATIONAL GRID ACCEPTS NO LIABILITY FOR ANY LOSS OR DAMAGE OF ANY KIND ARISING FROM THE USE OF THIS DRAWING. THE USER OF THIS DRAWING SHALL BE RESPONSIBLE FOR OBTAINING ALL NECESSARY PERMITS AND APPROVALS FROM THE APPROPRIATE AUTHORITIES. THE USER OF THIS DRAWING SHALL BE RESPONSIBLE FOR OBTAINING ALL NECESSARY PERMITS AND APPROVALS FROM THE APPROPRIATE AUTHORITIES. THE USER OF THIS DRAWING SHALL BE RESPONSIBLE FOR OBTAINING ALL NECESSARY PERMITS AND APPROVALS FROM THE APPROPRIATE AUTHORITIES.